

## Proper Use of Zippers

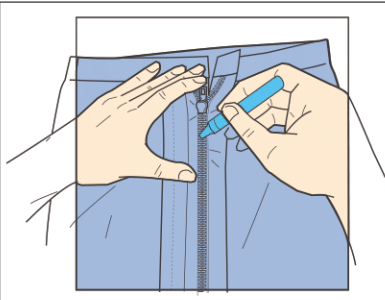

### 1 Rough Slider Operation

Do not force the slider even if it doesn't move smoothly, or it may cause the elements to misengage.

Apply paraffin or wax on both front and back surfaces of the elements, then move the slider back and forth to regain smooth operation.

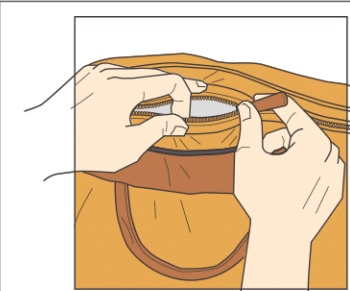

### 2 Pulled Out Elements

Trying to forcibly close the zipper of an overfilled bag will cause element and tape breakage due to the excess load on the elements.

Reduce the burden by reducing the content of the bag and by bringing both sides of the chain close to each other before closing the zipper.

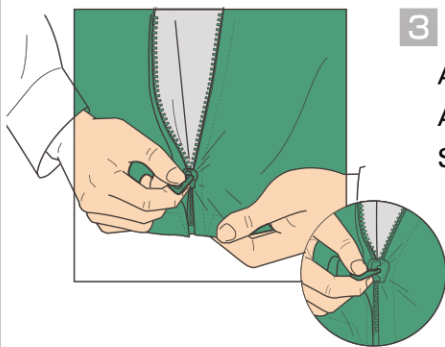

### 3 Fabric Caught in Slider

A slider may catch the fabric and get stuck during its operation. Avoid forcing it to move or it will worsen the problem.

Slowly move the slider while pulling out the caught fabric

Please allow enough room for the slider to move smoothly when sewing the zipper onto the fabric.

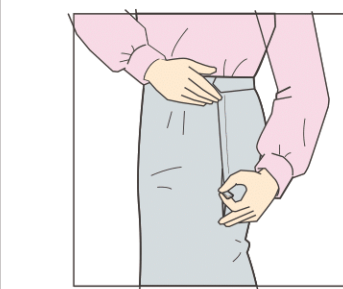

### 4 When Dressing / Undressing

Make sure to completely open the zipper when dressing / undressing. Dressing / undressing without completely opening the zipper may damage elements / slider function.

When closing the zipper, the slider will move more smoothly if the hook & eye or the top button is fastened beforehand.

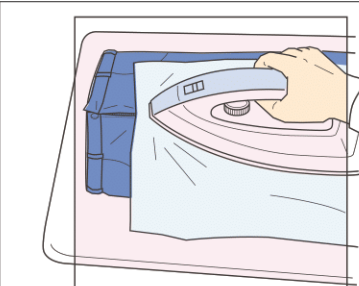

### 5 Proper Ironing Procedures

Not only the garment fabrics, but also zippers have appropriate ironing temperature according to their materials. Please keep the specified ironing temperature to maintain the zipper quality.

Also make sure to completely close the zipper, lay down the slider pull-tab in the regular position and place ironing fabric on the zipper.

CONCEAL®	160°C
FLATKNIT®	150°C
VISLON®	130°C
Coil Zippers	160°C

(Pressure: 1.5kg, Applied for 10 sec.)

※Direct ironing onto elements or sliders may cause undesirable effects.

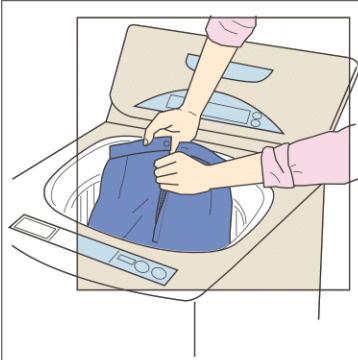

## 6 Proper Laundry Procedure

Make sure to completely close all the zippers when using the washing / drying machines. Incompletely closed zipper may be entangled with other load and result in element or slider damage or damage on other fabric.

Long or slim slider pull-tab may be caught in the drum holes and break, so the use of a laundry net for those items is recommended.

After the drying process, do not operate the zipper until the garment temperature has cooled down.

Strong alkaline detergent or chlorinated bleach may affect zipper operation. In that case, use softeners, paraffin or wax to regain the smoothness.

Do not presoak garment with zippers in washing solution, or it may cause significant damage.

## Proper Use of Open-End Zippers

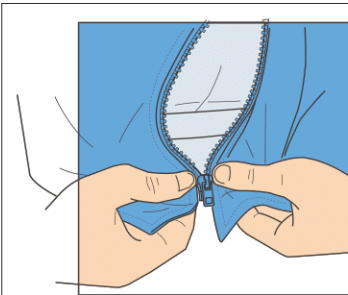

### 1 Open-End Zipper

#### ◆When closing

1. Completely pull down the slider until it touches the retainer box.
2. Fully insert the insert pin to the box. (Incomplete insertion may cause troubles.)
3. While holding the insert pin side with the right hand, pull up the slider with the left hand.

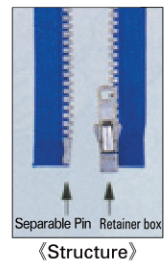

#### ◆When opening

1. Completely pull down the slider until it touches the retainer box.
2. Gently pull out the insert pin with the right hand

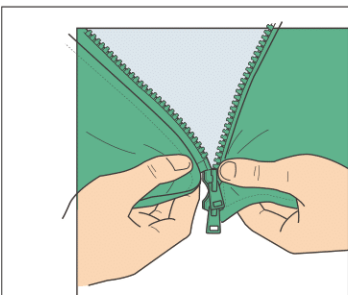
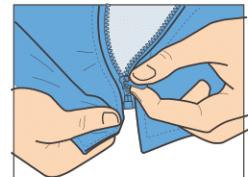

### 2 Two-Way Open

#### ◆When closing

1. Pull down the upper slider until it touches the bottom slider.
2. Insert the insert pin to the very bottom of the bottom slider. (Incomplete insertion may cause troubles.)
3. Pull up the upper slider with the left hand.

#### ◆When opening

1. Completely pull down the slider until it touches the bottom slider.
2. Gently pull out the insert pin with the right hand

